



» View More Buildings

Contact Property Manager



Building Details

Total Building Area:	3,770 square feet	Acquired by City:	April 27, 2021 Renovations scheduled for late 2021
Freezer Areas:	2,976 square feet	Office Area:	356 square feet
Area 1:	40' x 31'	Office Space:	17' x 20'
Area 2:	32' x 31'	Office Heat:	Electric Baseboard
Area 3:	19' x 31'	Restroom(s):	1
Celling Clearance:	9' to bottom of beam	Electrical:	3 Phase 208
Clear Span:	Yes	Loading Dock:	435 square feet
Overhead Door(s):	(0) Overhead (2) Sliding Doors		Covered Exterior 35' 6" x 10' Enclosed 8' x 10'
Lease Rate:	Negotiable	Location:	Skyway Industrial Park 750 Central Drive Presque Isle, Maine
Owner:	City of Presque Isle		
Contact:	Presque Isle Industrial Council		

Building Details & Floor Plan
Downloadable PDF document.

Location

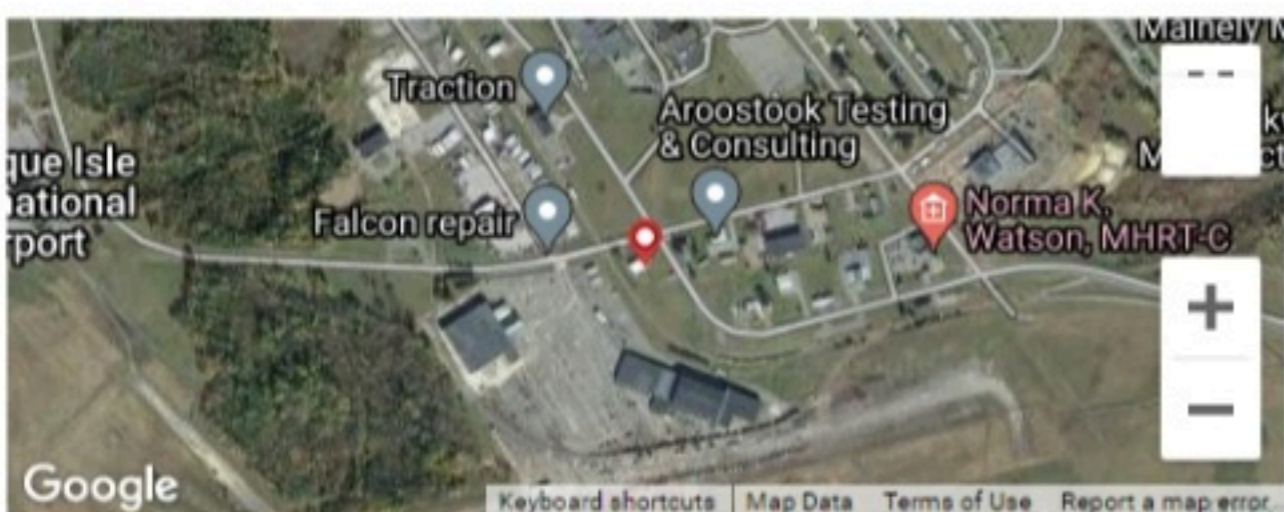

Floor Plan

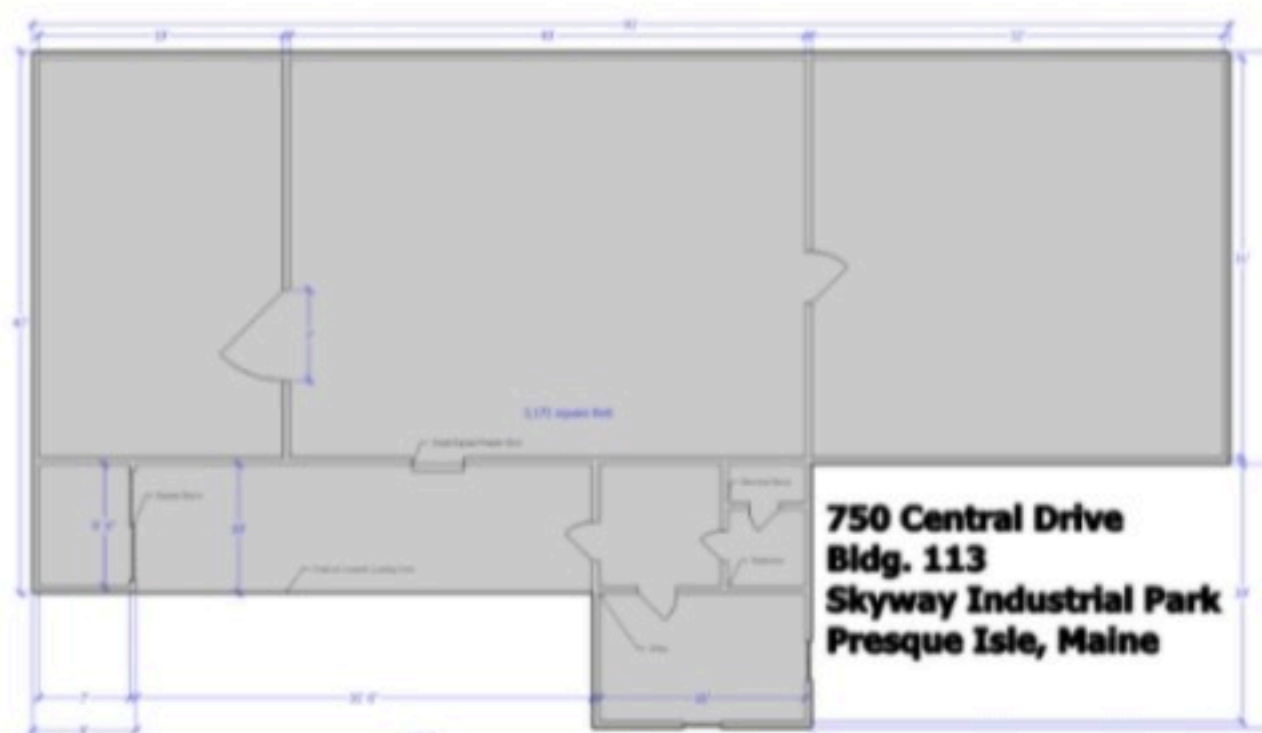

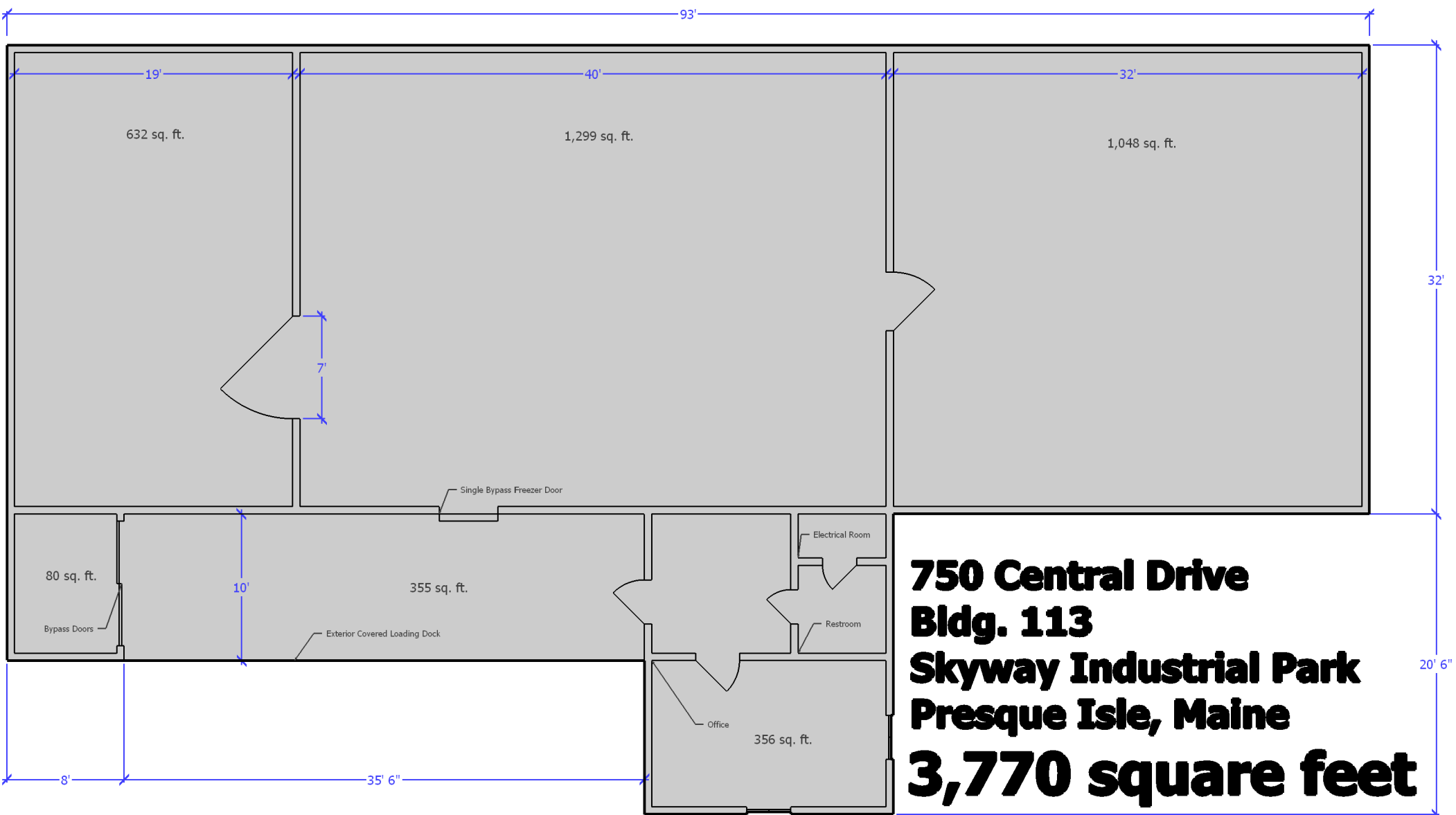

**750 Central Drive
Bldg. 113
Skyway Industrial Park
Presque Isle, Maine
3,770 square feet**